

Trascinamento singolo

CARTONGESSO SINGLE DRIVING FOR PLASTERBOARD WALLS

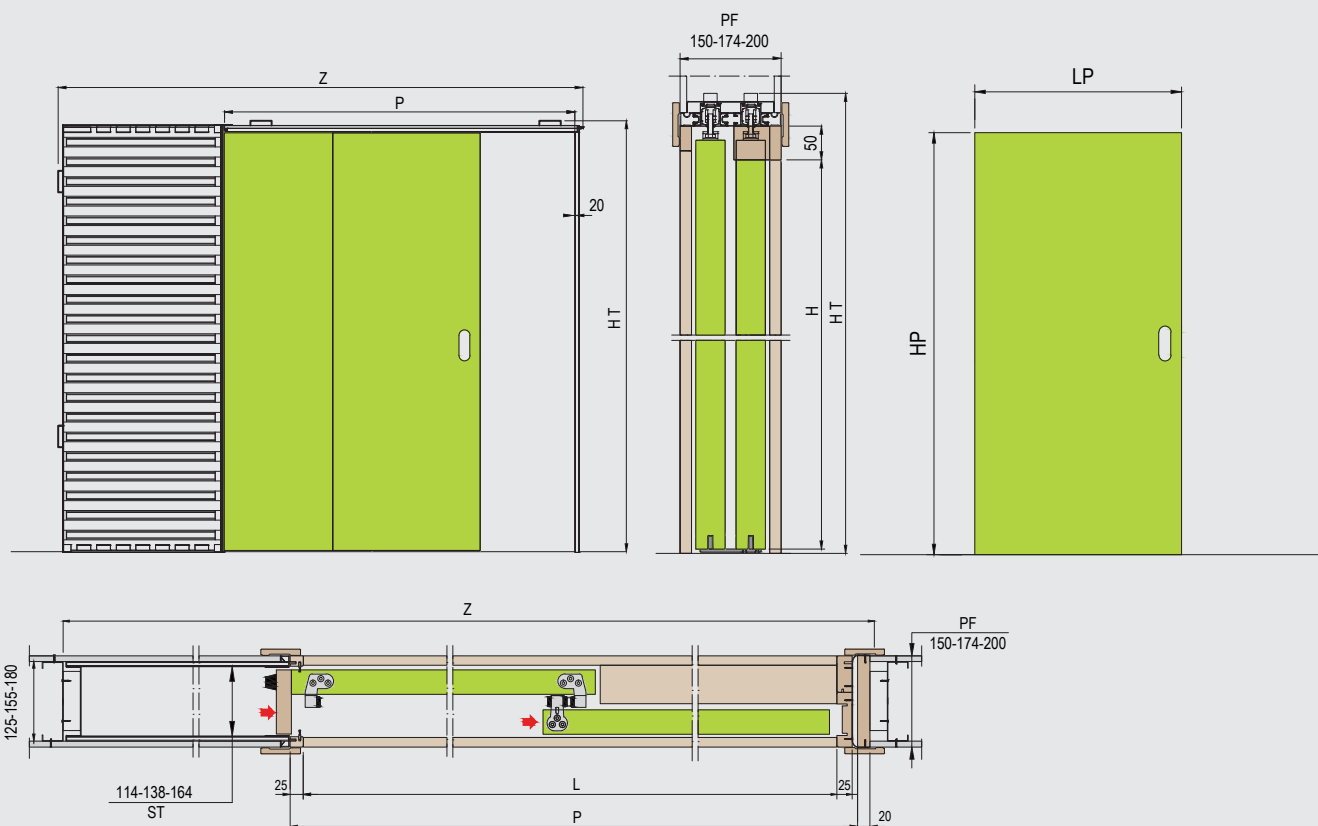

STANDARD

misure in mm - sizes in mm

L x H	Z	HT	P	ST	SC	PF	LP x HP
1200 (600x2) x 2000/2030/2100	1930	2100/2140/2200	1255	114/138/164	125/155/180	150/174/200	615÷630 x 2010/2040/2110
1400 (700x2) x 2000/2030/2100	2230	2100/2140/2200	1455	114/138/164	125/155/180	150/174/200	715÷730 x 2010/2040/2110
1600 (800x2) x 2000/2030/2100	2530	2100/2140/2200	1655	114/138/164	125/155/180	150/174/200	815÷830 x 2010/2040/2110
1800 (900x2) x 2000/2030/2100	2830	2100/2140/2200	1855	114/138/164	125/155/180	150/174/200	915÷930 x 2010/2040/2110
2000 (1000x2) x 2000/2030/2100	3130	2100/2140/2200	2055	114/138/164	125/155/180	150/174/200	1015÷1030 x 2010/2040/2110
2200 (1100x2) x 2000/2030/2100	3430	2100/2140/2200	2255	114/138/164	125/155/180	150/174/200	1115÷1130 x 2010/2040/2110
2400 (1200x2) x 2000/2030/2100	3730	2100/2140/2200	2455	114/138/164	125/155/180	150/174/200	1215÷1230 x 2010/2040/2110

NOTE TECNICHE

A richiesta sono disponibili altri controtelai a misura speciale con larghezze (L) a partire da 300x2 mm fino a 1200x2 mm ed altezze (H) a partire da 500 mm fino a 2700 mm.

Le misure intermedie in L e H del controtelaio variano di 50 mm.

La luce nominale (L) è ridotta di circa 25 mm.

Per il controtelaio con struttura (ST) da 114 mm è consigliabile l'utilizzo di pannelli porta con spessore max (SP) di 40 mm, compresi eventuali cornici fermavetro.

Per il fissaggio delle lastre in cartongesso sul controtelaio utilizzare le viti in dotazione (o comunque viti di lunghezza non superiore a 19 mm), forando in corrispondenza delle doghe di rinforzo del controtelaio.

Si consiglia l'utilizzo di lastre in cartongesso di 12,5 mm di spessore.

Portata standard dei carrelli in dotazione: 120 kg.

TECHNICAL INFORMATIONS

Special systems can be produced on demand with the width (L) starting from 300x2 mm up to 1200x2 mm, and height (H) from 500 mm up to 2700 mm.

Intermediate sizes L and H are available in increments of 50 mm.

The doorway (L) is reduced by an approximate 25 mm.

Systems with 114 mm structure (ST) are suitable for doors up to 40 mm thick (SP), including panel arch top door.

The screws supplied with the system are suitable for the 12,5 mm plaster board. The drilled have to be made in correspondance to the reinforcing boards of the pocket frame. Only screws less than 19 mm should be used with 12,5 mm plaster board.

It is advisable to use plaster boards of 12,5 mm thick.

Standard payload of the hanging kit supplied: 120 kg.